

SPECIFICATIONS

- 1、Current Rating: 3A AC, DC SEC:A-A
- 2、Voltage Rating: 250V AC, DC
- 3、Temperatuer Range: -25°C~+85°C
- 4、Contact Resistance: 20mΩ Max
- 5、Insulation Resistance: 1000MΩ Min
- 6、Withstanding Voltang: 1000V AC/minute
- 7、Material: Phosphoric bronze Tin-plated
- 8、Applicable Wire Sizes: AWG#22~28#

制图 DRAWN	变更内容 DESCRIPTION	日期 DATE	GENERAL TOLERANCE		制图 DRAWING	陈雅	品名 TITLE		www.ycelelectron.com	A
			X.±0.25	X.±2°	审核 CHECK	洪章波	TJC3端子			
			±0.20	±1°	核准 APPROVAL	魏杰	客户料号 CUST. NO.		页次 SHEET	1/1
			.XXX±0.10	.XX±0.5°	单位 UNITS	MM	比例 SCALE		1:1	

深圳市裕诚电子有限公司
 SHENZHEN YUCHENG ELECTRONICS CO., LTD

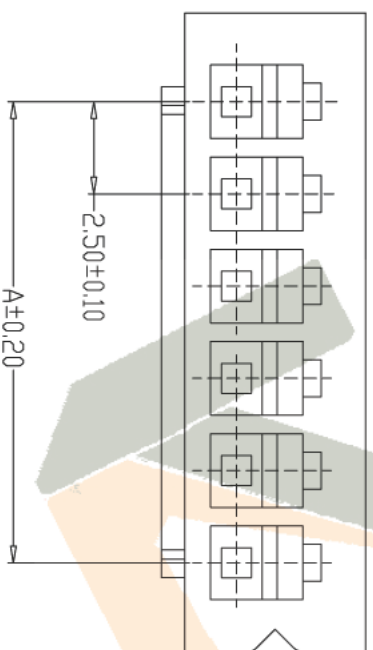
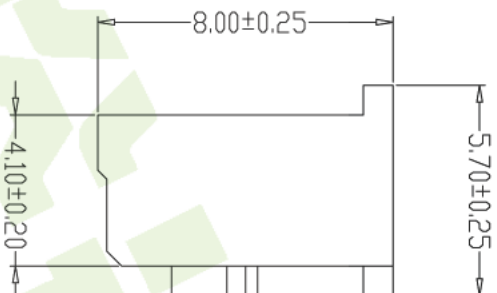
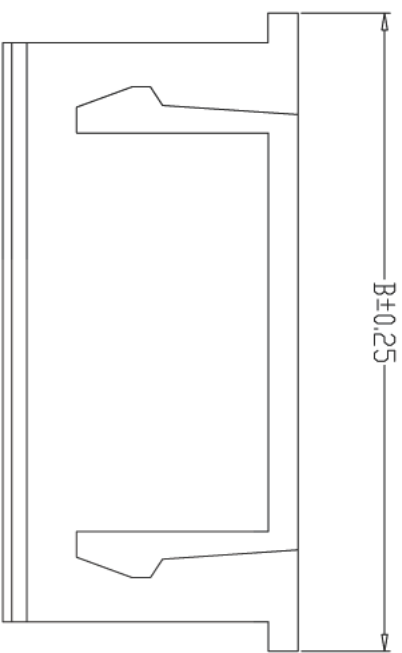

SPECIFICATIONS

- 1、Current Rating: 3A AC, DC
- 2、Voltage Rating: 250V AC, DC
- 3、Temperature Range: -25°C~+85°C
- 4、Contact Resistance: 20mΩ Max
- 5、Insulation Resistance: 1000 MΩ Min
- 6、Withstanding Voltage: 1000V AC/minute
- 7、Material: Nylon66, UL94V-0

编 号	尺寸 (mm)	
	A	B
A2501-02Y	2.50	7.50
A2501-03Y	5.00	10.00
A2501-04Y	7.50	12.50
A2501-05Y	10.00	15.00
A2501-06Y	12.50	17.50
A2501-07Y	15.00	20.00
A2501-08Y	17.50	22.50
A2501-09Y	20.00	25.00
A2501-10Y	22.50	27.50
A2501-11Y	25.00	30.00
A2501-12Y	27.50	32.50
A2501-20Y	47.50	52.50

制图 DRAWN	变更内容 DESCRIPTION	日期 DATE	GENERAL TOLERANCE	
-------------	---------------------	------------	-------------------	--

制图 DRAWING	制图 DRAWN
---------------	-------------

陈雅

www.ycelelectron.com

X.±0.25	X.±2°
---------	-------

审核 CHECK	审核 CHECK
-------------	-------------

洪章波

品名
TITLE

TJ03孔座

页次
SHEET

.X±0.15	.XX±0.5°
---------	----------

核准 APPROVAL	核准 APPROVAL
----------------	----------------

魏杰

客户料号
CUST. NO.



.XXX±0.10	.XXX±0.5°
-----------	-----------

单位 UNITS	单位 UNITS
-------------	-------------

MM

比例
SCALE

1:1

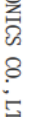

深圳市裕诚电子有限公司
SHENZHEN YUCHENG ELECTRONICS CO., LTD

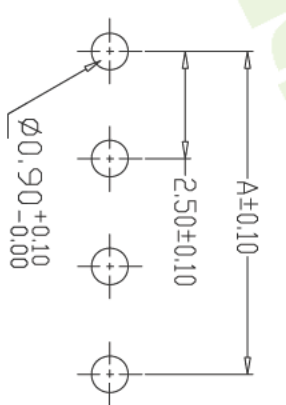
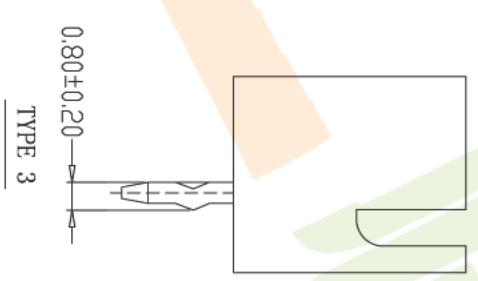
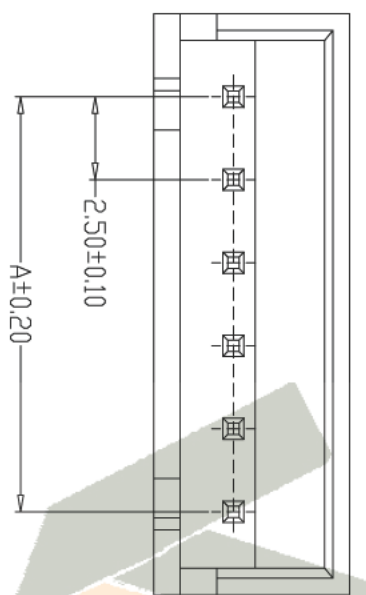
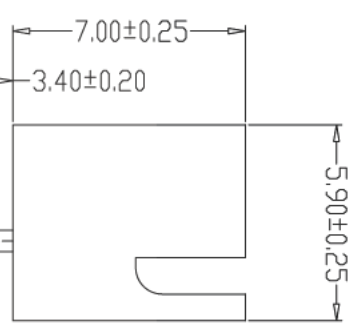
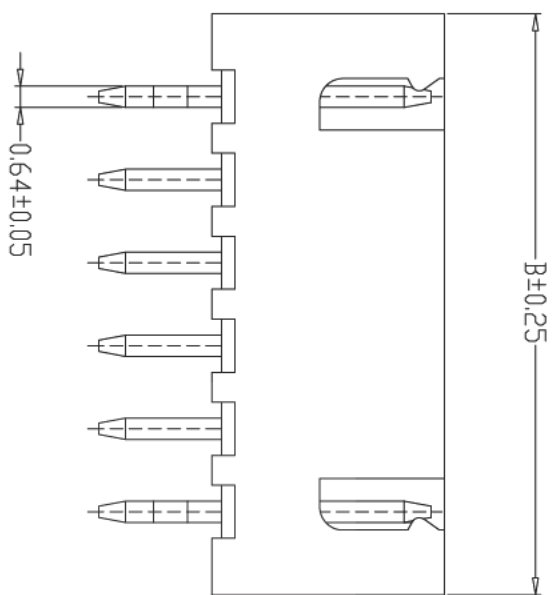

PCB LAYOUT

- SPECIFICATIONS**
- 1、Current Rating: 3A AC, DC
 - 2、Voltage Rating: 250V AC, DC
 - 3、Temperature Range: -25°C~+85°C
 - 4、Contact Resistance: 20mΩ Max
 - 5、Insulation Resistance: 1000MΩ Min
 - 6、Withstanding Voltage: 1000V AC/minute
 - 7、Material: Wafer Nylon66, UL94V-0
PIN Brass Tin-plated

编号	尺寸 (mm)	
	A	B
A2501-02A	2.50	7.50
A2501-03A	5.00	10.00
A2501-04A	7.50	12.50
A2501-05A	10.00	15.00
A2501-06A	12.50	17.50
A2501-07A	15.00	20.00
A2501-08A	17.50	22.50
A2501-09A	20.00	25.00
A2501-10A	22.50	27.50
A2501-11A	25.00	30.00
A2501-12A	27.50	32.50
A2501-20A	47.50	52.50

制图	变更内容	日期
DRAWN	DESCRIPTION	DATE

GENERAL TOLERANCE		制图
X.±0.25	X.±2°	DRAWING
.X±0.20	.X±1°	审核
.XX±0.15	.XX±0.5°	检查
.XXX±0.10	.XXX±0.5°	核准

PCB LAYOUT		单位	比例
		UNITS	SCALE
		MM	1:1

陈雅	洪章波	魏杰
品名	TJ03 直针	品名
客户料号	WAFFER DIP TYPE	客户料号
CITL. NO.		CITL. NO.

www.ycelelectron.com

深圳市裕城电子有限公司

SHENZHEN YUCHENG ELECTRONICS CO., LTD

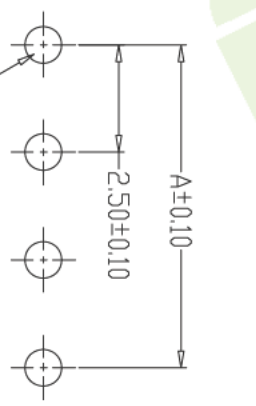
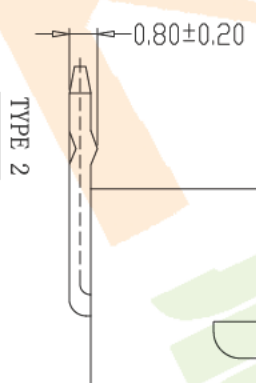
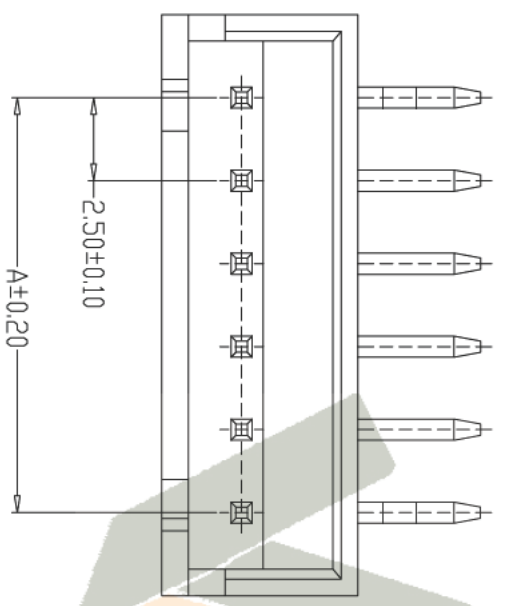
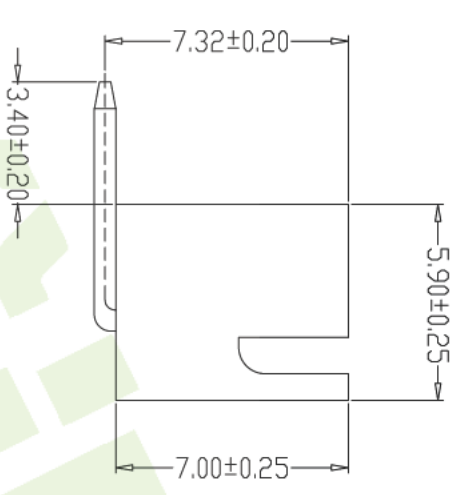
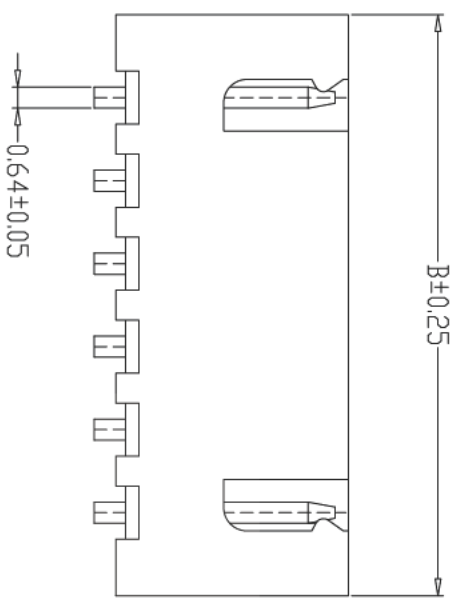

PCB LAYOUT

- SPECIFICATIONS
- 1、Current Rating: 3A AC, DC
 - 2、Voltage Rating: 250V AC, DC
 - 3、Temperature Range: -25°C~+85°C
 - 4、Contact Resistance: 20mΩ Max
 - 5、Insulation Resistance: 1000MΩ Min
 - 6、Withstanding Voltage: 1000V AC/minute
 - 7、Material: Wafer Nylon66, UL94V-0
PIN Brass Tin-plated

编号	尺寸 (mm)	
	A	B
A2501-02AW	2.50	7.50
A2501-03AW	5.00	10.00
A2501-04AW	7.50	12.50
A2501-05AW	10.00	15.00
A2501-06AW	12.50	17.50
A2501-07AW	15.00	20.00
A2501-08AW	17.50	22.50
A2501-09AW	20.00	25.00
A2501-10AW	22.50	27.50
A2501-11AW	25.00	30.00
A2501-12AW	27.50	32.50
A2501-20AW	47.50	52.50

制图 DRAWN	变更内容 DESCRIPTION	日期 DATE	GENERAL TOLERANCE	制图 DRAWING	陈雅	品名 TITLE	www.ycelelectron.com
			X.±0.25	审核 CHECK	洪章波	TJG3等针	
			.X±0.20	核准 APPROVAL	魏杰	客户料号	
			.XX±0.15			CUTL. NO.	
			.XXX±0.10				

比例 SCALE	1:1	单位 UNITS	MM
深圳市裕城电子有限公司 SHENZHEN YUCHENG ELECTRONICS CO., LTD			

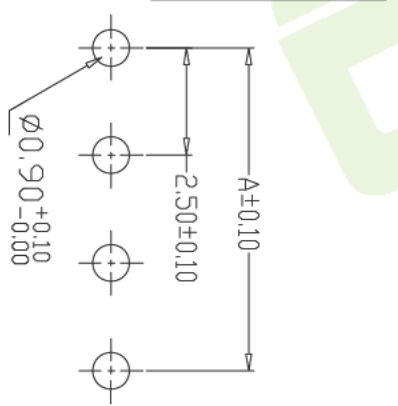
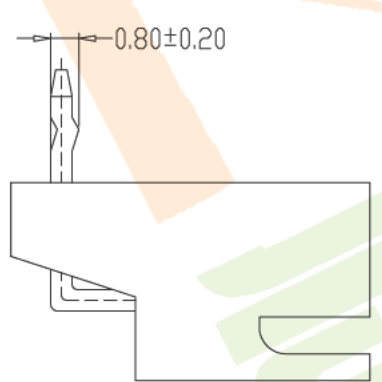
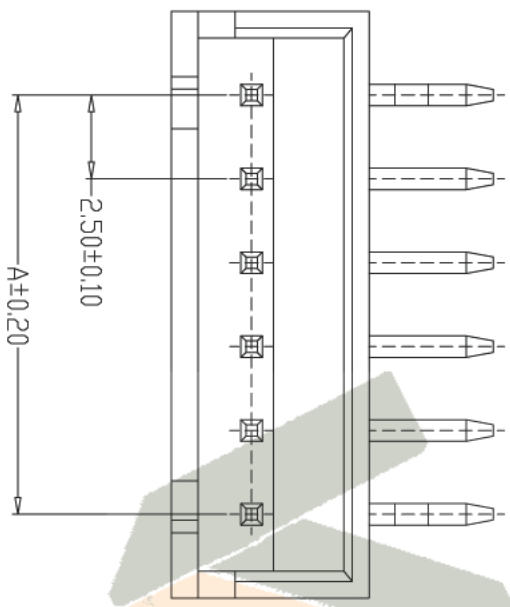
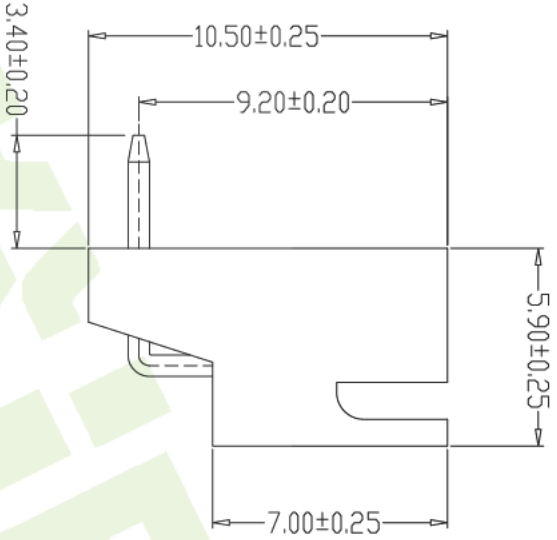
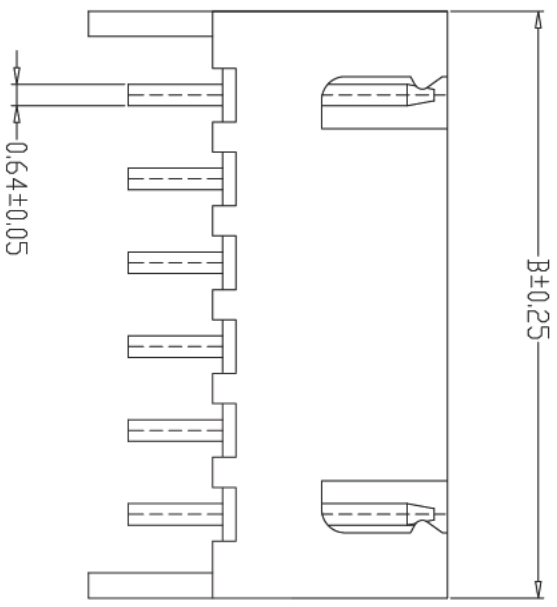

- SPECIFICATIONS**
- 1、Current Rating: 3A AC, DC
 - 2、Voltage Rating: 250V AC, DC
 - 3、Temperature Range: -25°C~+85°C
 - 4、Contact Resistance: 20mΩ Max
 - 5、Insulation Resistance: 1000MΩ Min
 - 6、Withstanding Voltage: 1000V AC/minute
 - 7、Material: Wafer Nylon66, UL94V-0
PIN Brass Tin-plated

PCB LAYOUT

编 号	尺寸 (mm)	
	A	B
A2501-02AWD	2.50	7.50
A2501-03AWD	5.00	10.00
A2501-04AWD	7.50	12.50
A2501-05AWD	10.00	15.00
A2501-06AWD	12.50	17.50
A2501-07AWD	15.00	20.00
A2501-08AWD	17.50	22.50
A2501-09AWD	20.00	25.00
A2501-10AWD	22.50	27.50
A2501-11AWD	25.00	30.00
A2501-12AWD	27.50	32.50
A2501-20AWD	47.50	52.50

制 图 DRAWN	变更内容 DESCRIPTION	日 期 DATE	制 图 DRAWING	品 名 TITLE	www.ycelectron.com
			审 核 CHECK	TJG3定位弯针 WAFFER DIP TYPE	页 次 SHEET
			核 准 APPROVAL	客户料号 CUST. NO.	1/1

GENERAL TOLERANCE	X.±0.25	X.±0.25	单 位 UNITS	MM	比 例 SCALE	1:1
	.X±0.20	.X±1°				
	.XX±0.15	.XX±0.5°				
	.XXX±0.10	.XXX±0.5°				

深圳市裕诚电子有限公司
 SHENZHEN YUCHENG ELECTRONICS CO., LTD

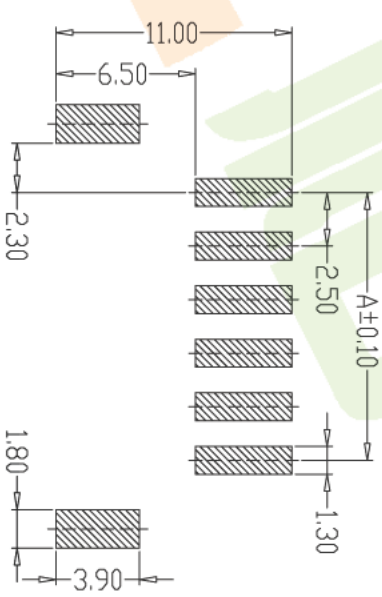
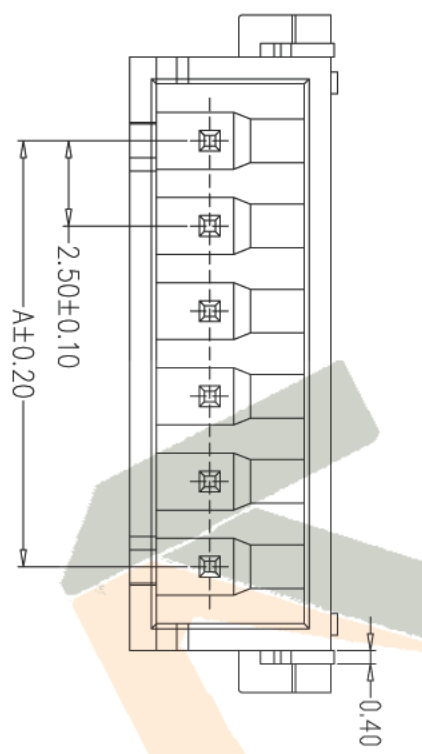
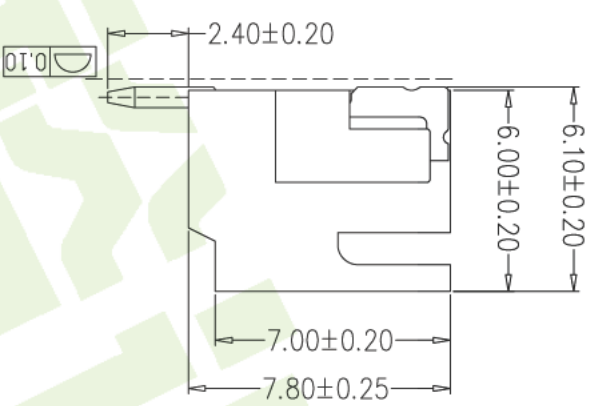
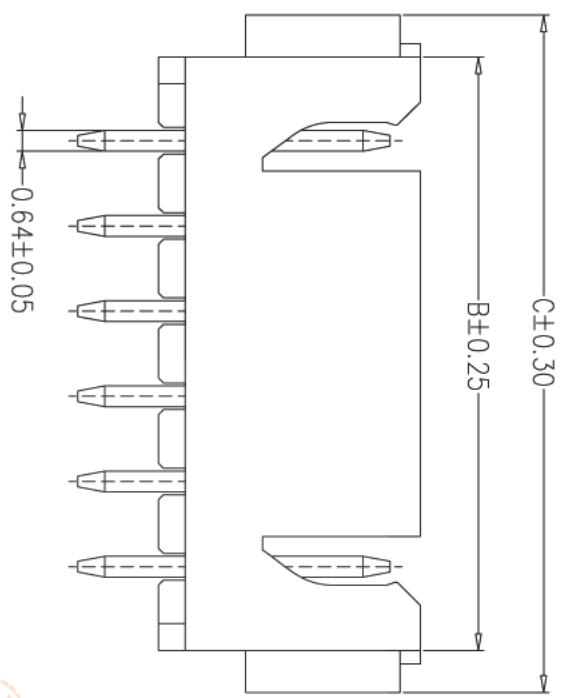

PCB LAYOUT

- SPECIFICATIONS**
- 1、Current Rating: 3A AC, DC
 - 2、Voltage Rating: 250V AC, DC
 - 3、Temperature Range: -25°C~+85°C
 - 4、Contact Resistance: 20mΩ Max
 - 5、Insulation Resistance: 1000MΩ Min
 - 6、Withstanding Voltage: 1000V AC/minute
 - 7、Material: Wafer LCP, PA6T, UL94V-0
- PIN Brass Tin-plated
Solder tad Brass Tin-plated

编号	尺寸 (mm)		
	A	B	C
A2501WF-02A	2.50	7.50	10.00
A2501WF-03A	5.00	10.00	12.50
A2501WF-04A	7.50	12.50	15.00
A2501WF-05A	10.00	15.00	17.50
A2501WF-06A	12.50	17.50	20.00
A2501WF-07A	15.00	20.00	22.50
A2501WF-08A	17.50	22.50	25.00
A2501WF-09A	20.00	25.00	27.50
A2501WF-10A	22.50	27.50	30.00
A2501WF-11A	25.00	30.00	32.50
A2501WF-12A	27.50	32.50	35.00
A2501WF-20A	47.50	52.50	55.00

制图	变更内容	日期	GENERAL TOLERANCE		制图	比例	
DRAWN	DESCRIPTION	DATE	X.±0.25	X.±2°	DRAWING	MM	SCALE
			.X±0.20	X.±1°	审核		1:1
			.XX±0.15	.XX±0.5°	检查		
			.XXX±0.10	.XXX±0.5°	核准		
					单位		
					UNITS		
					魏杰		
					洪章波		
					陈雅		
			www.yceletron.com		品名	A	
					TITLE	贴片	
					客户料号	WAFER SMT TYPE	
					CITL. NO.	SHEET	
						1/1	

深圳市裕城电子有限公司
SHENZHEN YUCHENG ELECTRONICS CO., LTD

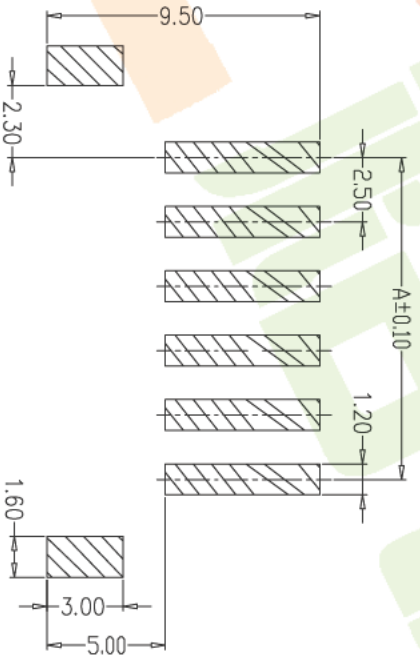
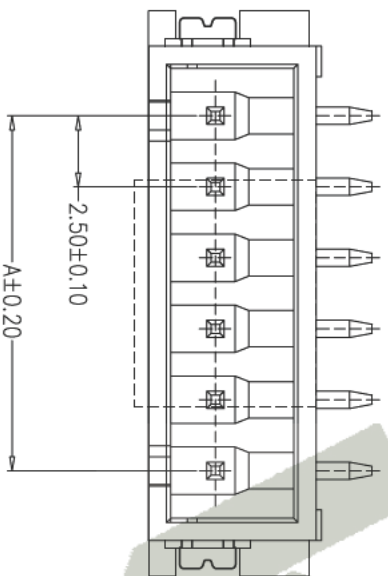
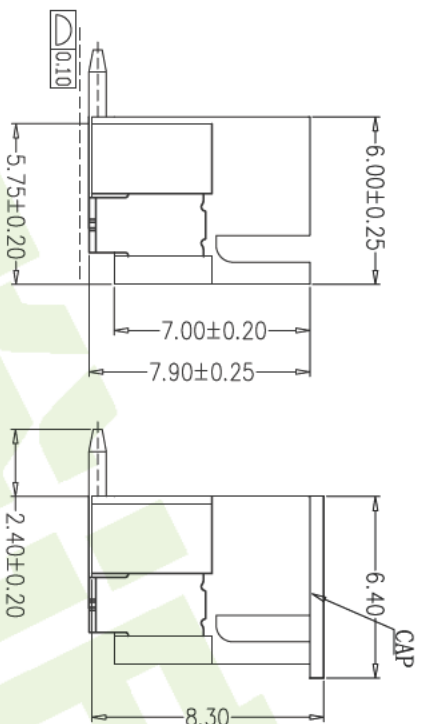
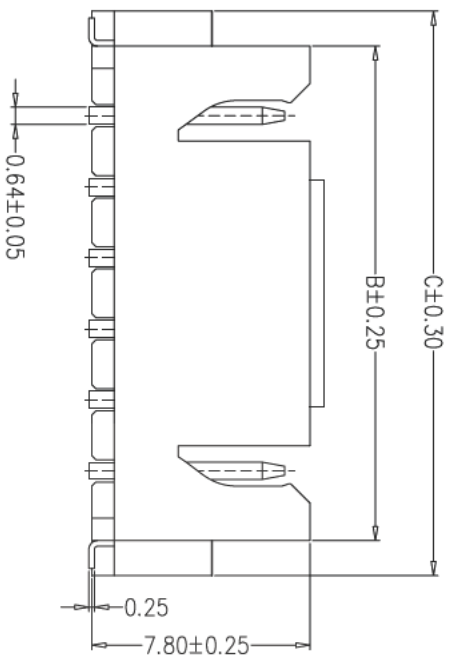

PCB LAYOUT

SPECIFICATIONS

- 1、Current Rating: 3A AC, DC
- 2、Voltage Rating: 250V AC, DC
- 3、Temperature Range: -25°C~+85°C
- 4、Contact Resistance: 20mΩ Max
- 5、Insulation Resistance: 1000MΩ Min
- 6、Withstanding Voltage: 1000V AC/minute
- 7、Material: Wafer LCP, PA6T, UL94V-0
PIN Brass Tin-plated
Solder tad Phosphoric bronze Tin-plated

编号	尺寸 (mm)		
	A	B	C
A25011F-02A	2.50	7.50	10.00
A25011F-03A	5.00	10.00	12.50
A25011F-04A	7.50	12.50	15.00
A25011F-05A	10.00	15.00	17.50
A25011F-06A	12.50	17.50	20.00
A25011F-07A	15.00	20.00	22.50
A25011F-08A	17.50	22.50	25.00
A25011F-09A	20.00	25.00	27.50
A25011F-10A	22.50	27.50	30.00
A25011F-11A	25.00	30.00	32.50
A25011F-12A	27.50	32.50	35.00
A25011F-20A	47.50	52.50	55.00

制图
DRAWN

变更内容
DESCRIPTION

日期
DATE

GENERAL TOLERANCE

制图
DRAWING

陈雅

www.ycelectron.com

X.±0.25

X.±2°

洪章波

TJG3立贴
WAFFER SMT TYPE

.X±0.20

.X.±1°

魏杰

客户料号
CUTL. NO.

.XX±0.15

.XX.±0.5°

比例
SCALE

1:1

.XXX±0.10

.XXX.±0.5°

MM

深圳市裕城电子有限公司
SHENZHEN YUCHENG ELECTRONICS CO., LTD